

Quick-Lock Connectors

If it has to be quick!



**THE System
for Solvent Safety**

Advantages

- **Drip protection**, thanks to integrated locking valve
- **Closed system**, for drip-free separation
- Very little air ingress
- **Minimal contamination**
- No outwashing of air bubbles from the system is necessary
- Intuitive connection
- User-friendly, ergonomic design enables a safe and reliable connection
- Chemically resistant materials
- Secure connection and reliable performance for many applications

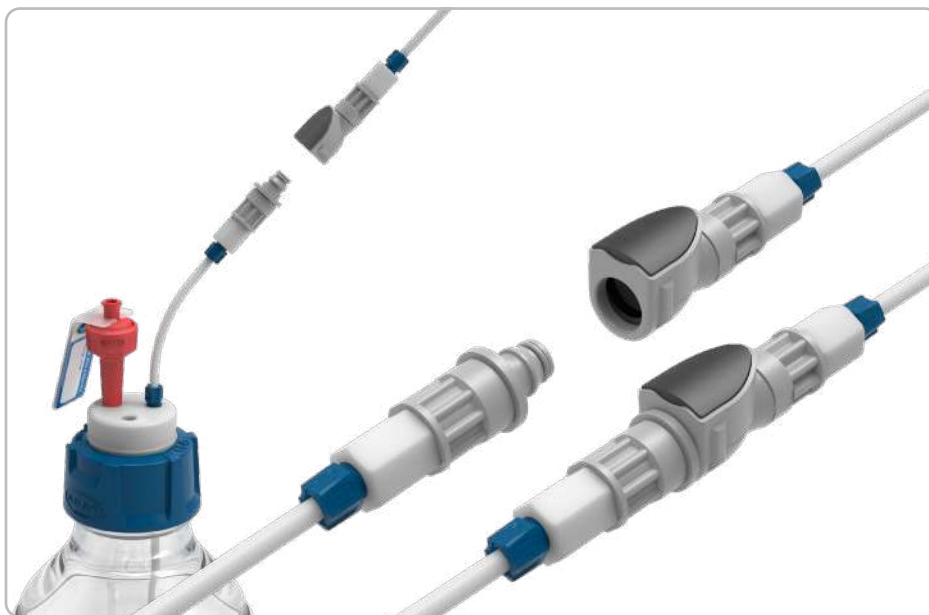

Specifications

Pressure	Vacuum 15 psi @ 1.0 bar
Temperature	0°C to 49°C (32°F to 120°F)
Materials	Main Components: Glass-filled Polypropylene, PEEK, Polypropylene Lock: PEEK® Springs: Stainless Steel 316 O-Rings: EPDM
Colour	Grey
Capillary Size:	3.2 mm OD (1/8") 2.3 mm OD 1.6 mm OD (1/16")
Discharge	0.02 cc per disconnection @ 15 psi
Uptake	0.01 cc per connection

A Quick-Lock Connector Set 1

360 189



- For safe connecting of capillaries
- Suitable for capillaries with outer diameters of 3.2 / 2.3 / 1.6 mm
- PFA fittings in all 3 sizes are included in the scope of supply
- Contains Part Nos. 360 190 + 360 179

B Quick-Lock Connector (m)

360 190

- Spare parts for Set 360 189
- Incl. 3 PFA fittings (3.2 / 2.3 / 1.6 mm ID)



C Quick-Lock Connector (f)

360 179

- Spare parts for Set 360 189
- Incl. 3 PFA fittings (3.2 / 2.3 / 1.6 mm ID)

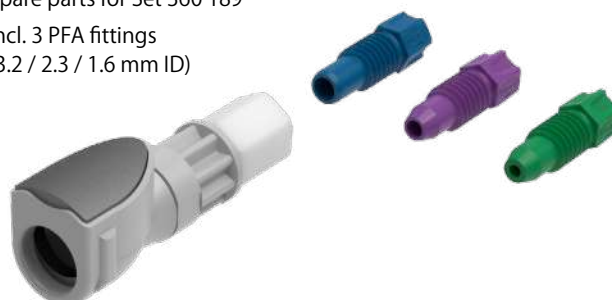



D Quick-Lock Set II (for Safety Caps)

360 183

- Fast connecting to, and disconnecting from, HPLC units and solvent bottles, with a "click"!



- Suitable for capillaries with outer diameters 3.2 / 2.3 / 1.6 mm
- PFA fittings and sealing balls, in all 3 sizes, are contained within the scope of supply
- Consists of Part Nos. 360 180 + 360 179

E 360 180

- Quick-lock connector (m) / Adapter for Safety Caps
- Incl. 3 PTFE sealing balls (3.2 / 2.3 / 1.6 mm ID)

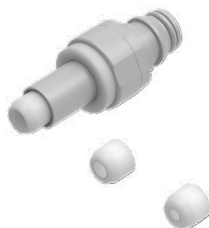

C Quick-Lock Connector (f)

360 179

- Spare parts for Set 360 183
- Incl. 3 PFA fittings (3.2 / 2.3 / 1.6 mm ID)



Ordering Information

Fig.	Part No.	Description	PU
A	360 189	Quick-Lock Connector Set I for capillaries Contains 360 190 (B) and 360 179 (C)	1 pc.
B	360 190	Quick-Lock Connector (m)	1 pc.
C	360 179	Quick-Lock Connector (f)	1 pc.
D	360 183	Quick-Lock Connector Set II for Safety Caps With adapter for screwing into the standard connectors of Safety Caps (UNF 1/4" 28G)	1 pc.
E	360 180	Quick-Lock Connector (m) for screwing into the standard connectors of Safety Caps (UNF 1/4" 28G)	1 pc.



S.C.A.T. Europe GmbH

Waldecker Straße 7
64546 Mörfelden-Walldorf
Germany



+49 (0) 61 05 / 30 55 86 - 0

@ info@scat-europe.com

www.scat-europe.com